

REV.	ECN NO.	DATE

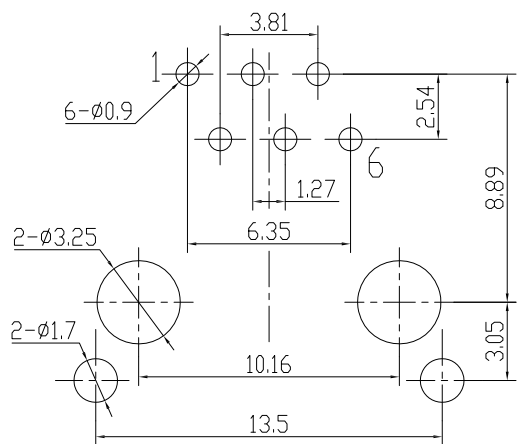
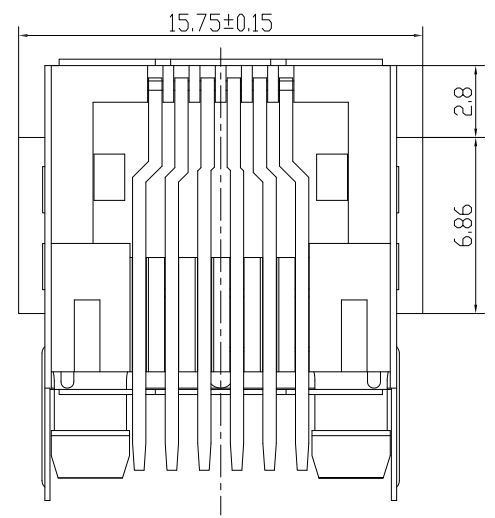
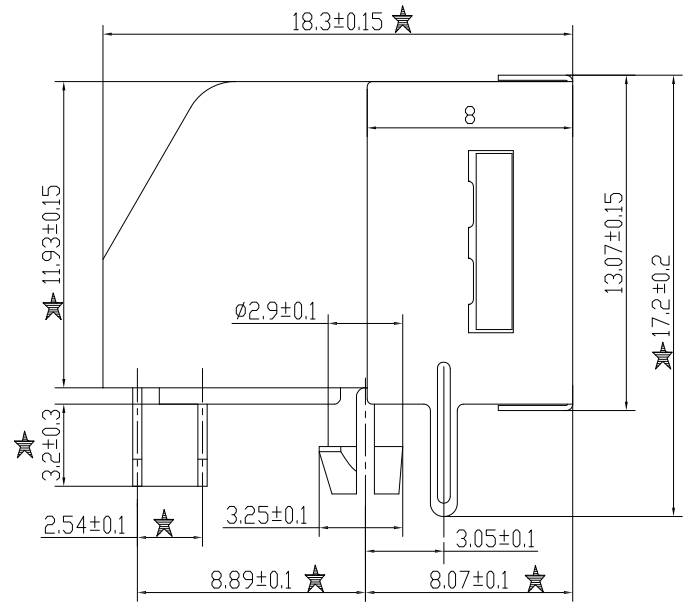
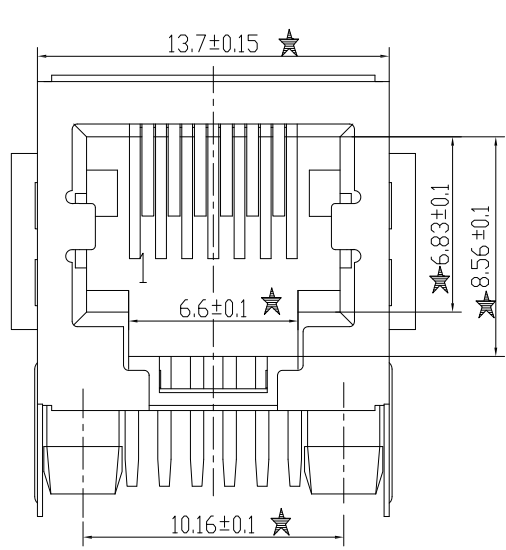

PCB LAYOUT

SPECIFICATION NOTES:

ELECTRICAL:

- VOLTAGE RATING: 125 VAC RMS
- CURRENT RATING: 1.5 AMP
- CONTACT RESISTANCE: 20mΩ MAX.
- INSULATION RESISTANCE: 1000MΩ MIN. AT 500V DC.
- DIELECTRIC STRENGTH: 1000 V AC OR 1500V DC RMS AT 0.5mA 50 Hz / 60 Hz FOR 1 MINUTE

MECHANICAL:

- HOUSING: PBT UL94V-0, BLACK.
- CONTACT MATERIAL: 0.46x0.36MM PHOSPHOR BRONZE

- PLATING: GOLD PLATING AT CONTACT AREA, NICKEL 30U MIN. OVER ALL
- SHELLED: H65Y T=0.2mm PLATED NICKEL FOR ALL
- OPERATING LIFE: 750 CYCLES MIN.
- MATING/UNMATING FORCE: 30N/3.06KG MAX.
- RETENTION STRENGTH: 50N MIN. FOR 60S±5S

ENVIRONMENTAL:

- STORAGE: -40° C TO +85° C RELATIVE HUMIDITY<80%
- GUARANTEE PERIOD: 12 MONTHS
- OPERATION: -40° C TO +85° C

RoHS Compliant

Coorle Technology

<p>TOLERANCES</p> <p>0~15±0.15, 15~30±0.2, 30~±0.25 ANGLE±1°.</p>	MATERIAL:	SEE NOTE	Designed:	NAME: PCB JACK 5722-S-H 6P	
	FINISH:	SEE NOTE	Checked:	DWG NO.:	REV
	SHEET	1 OF 1	Approved:	PART NO.:	RJ255721-66GF-014

		SCALE	UNIT	CUSTOMER:
		3.5:1	mm	MODEL NO.: